

Bituthene® 2000

Pre-formed self-adhesive rubber bitumen/high density polyethylene damp proof membrane

Features

- Damp proof - moisture/vapour proof barrier capable of resisting hydrostatic head conditions up to 5 metres.
- Flexible - accommodates minor settlement and shrinkage movement.
- Cold applied - no heating, simple, low labour cost.
- Self-adhesive - full continuity at overlaps.
- Factory controlled thickness - no variation by site labour.
- Rubber/bitumen - flexibility and resistance to most dilute acids and alkalis.
- Preformed film surface - immediate access for same day screeding.

Applications

Bituthene® 2000 is a combination of a high density polyethylene film and a self-adhesive rubber/bitumen compound. It is supplied in rolls 1 mm thick overall, 1 m wide and 30 m long (30 sq metres) and is unrolled sticky side down on to blinded hardcore or structural concrete slabs. Waterproof joints are made by overlapping 50 mm and firmly rolling surfaces.

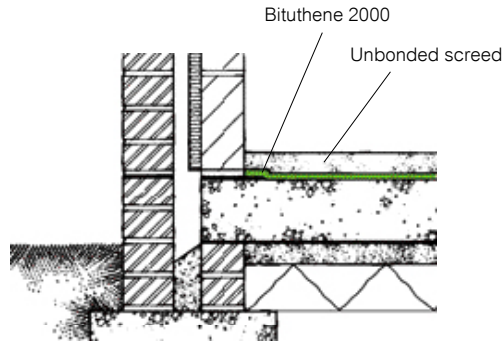

Moisture/vapour proof barrier at slabs on grade

Applied to top of concrete slab or blinded hardcore, Bituthene 2000 will provide a moisture/vapour proof barrier and radon gas barrier.

Being factory made, thickness of membrane is constant throughout and is not subjected to variations by site labour such as occurs with brush applied materials. Bituthene 2000 is flexible and well capable of bridging shrinkage cracks in the concrete.

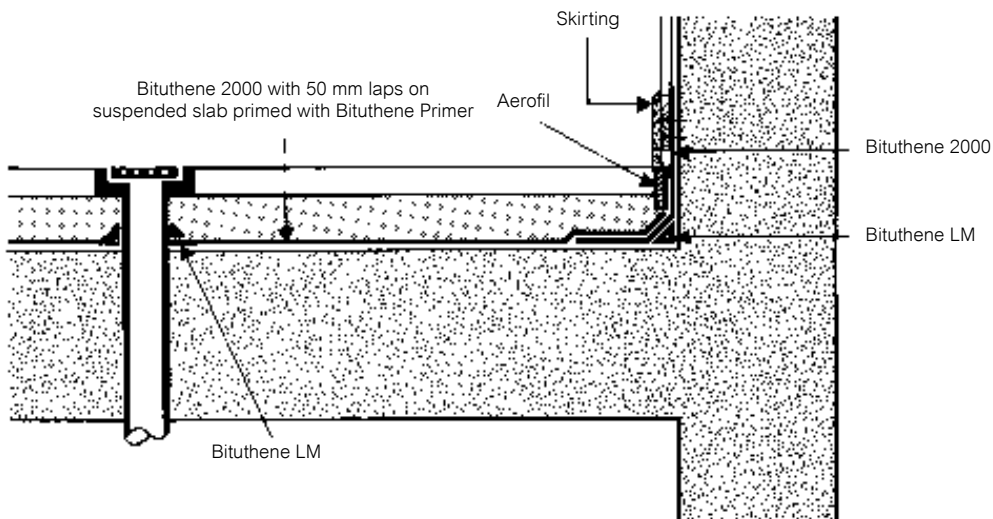

Moisture/vapour proof barrier for suspended slabs

Performance

Bituthene 2000 - typical performance properties

Property	Typical Values	Test Method
Colour	Dark Grey/Black	N/A
Tensile Strength (film only)	40,000 kN/m ²	ASTM D882
Tape Strength	5.10 N/mm	ASTM D412
Elongation of membrane (to ultimate failure of rubberised asphalt)	150%	ASTM D412
Lap adhesion @ 23°C	648 N/m	ASTM D1876
Puncture resistance	>220N	ASTM E154
Resistance to Hydrostatic head	60 m	ASTM D5385
Tear resistance	32 N/mm	ASTM D624
Permeance	1.6 ng/m ² .s.Pa	ASTM E96 [12]

Typical Test Values may represent average values from samples tested. Test Methods noted may be modified.

Supply

Bituthene 2000 1 m x 30 m roll (30 sq m)
Weight 40 kg gross
Storage Store upright in dry conditions
below +35°C

Ancillary Materials

Bituthene Primer 18 litre pails
Coverage 6 ~ 8 sq metre per litre depending
on method of application, surface
texture, porosity and ambient
temperature

Bituthene Mastic 850cc cartridges,
3 litre can

Bituthene LM 5.7 litre pails

is printed on the membrane. Following the application care should be taken to prevent damage by following trades. Damaged areas can be repaired by patching with an oversize patch applied to a clean dry surface and firmly rolled.

Health and Safety

Refer to relevant Material Health and Safety data sheets.

Quality Assurance

W. R. Grace (Singapore) Pte Ltd is certified to ISO 9002 Quality Systems by SISIR (Singapore Institute of Standard & Industrial Research) for the manufacture of Bituthene Waterproofing Membranes under the registered certification number ISO 93-2-0269.

Installation

Concrete slab or concrete blinded hardcore shall be surface dry, free from standing water, and laid to a regular surface free from sharp protrusions and hollows. Vertical faces shall be smooth, regular, dry and free from nails and primed with one coat of Bituthene Primer applied by brush or roller, at a rate depending on the porosity of the surface and allowed to dry before the application of the Bituthene 2000. Brickwork must be flush pointed or rendered to provide a smooth surface. Bituthene 2000 shall be laid by peeling back the protective release paper and applying the adhesive face on to the prepared surface. The material should be brushed on to the surface to exclude air. Adjacent rolls are aligned and overlapped 50 mm minimum at side and ends and well rolled with a firm pressure using a Bituthene Lap Roller to ensure completed adhesion and continuity between the layers. A guideline

Specification

Bituthene 2000 preformed membrane shall be laid on to smooth concrete surface, or concrete blinded hardcore by applying the preformed membrane, sticky side downwards to give well rolled 50 mm overlaps, laid strictly in accordance with the manufacturer's instructions and supplied by Grace Construction Products. For further information, contact your local Grace representative.

Grace Technical Services

For assistance with working drawings for projects and additional technical advice, please contact Grace Technical Services.

www.graceconstruction.com

Australia 1800 855 525 New Zealand (64-9) 448 1146 China Mainland (86-21) 5467 4678
Hong Kong (852) 2675 7898 Indonesia (62-21) 893 4260 Japan (81-3) 3537 6366 Korea (82-32) 820 0800
Malaysia (60-3) 9074 6133 Philippines (63-49) 549 7373 Singapore (65) 6265 3033 Taiwan (886-3) 427 0850
Thailand (66-2) 709 4470 Vietnam (84-8) 3710 6168

Bituthene is a registered trademark of W. R. Grace & Co.-Conn.

The information given is based on data and knowledge considered to be true and accurate and is offered for the user's consideration, investigation and verification. Since the conditions of use are beyond our control we do not warrant the results to be obtained. Please read all statements, recommendations or suggestions in conjunction with our conditions of sale including those limiting warranties and remedies which apply to all goods supplied by us. No statement, recommendation or suggestion is intended for any use which would violate or infringe statutory obligations or any rights belonging to a third party.

These products may be covered by patents or patents pending. Copyright 2014. W. R. Grace (S) Pte Ltd 110-BIT-9B
Printed in Singapore 02/14